

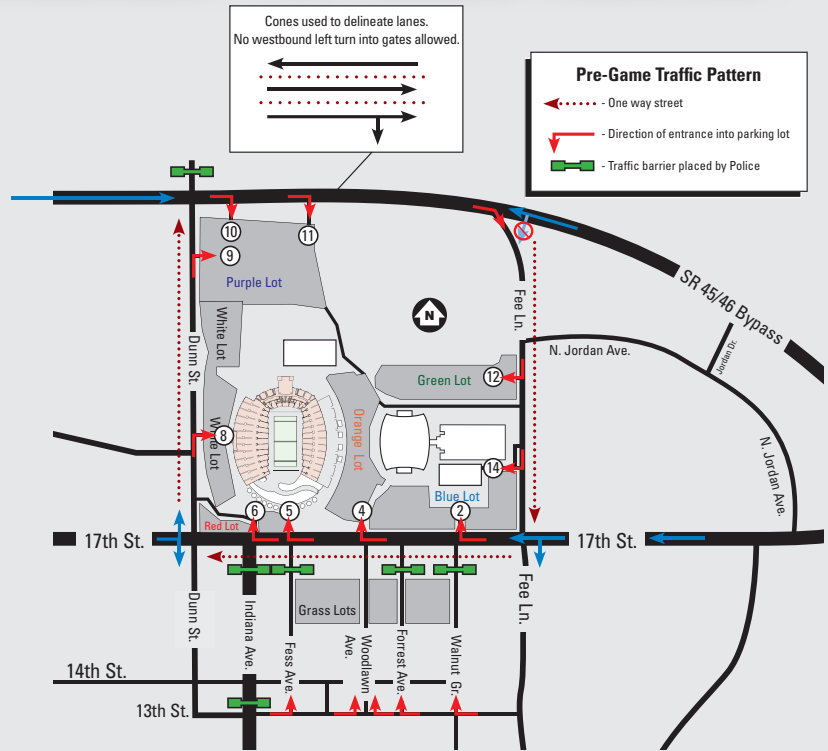

# MEMORIAL STADIUM PRE-GAME TRAFFIC

A new traffic pattern will take effect for the 2009 IU Football season:

- One-way traffic patterns will go into effect a minimum of **2 hours** prior to kickoff each game.
- **The 45/46 Bypass will remain two-way with two eastbound lanes** to the stadium. Westbound traffic traveling between Fee Lane and Dunn St. will not be allowed to enter Stadium lots.
- **Fee Lane will be one-way south** between the 45/46 Bypass and 17th Street (two lanes).
- **Dunn Street will be one-way north** from 17th Street to the 45/46 Bypass (two lanes).
- **17th Street will be one-way west** from Fee Lane to Dunn Street (two lanes).
- **Indiana Avenue will be closed** between 13th Street and 17th Street.



## PURPLE LOT (GATES 9, 10 AND 11)

### Gate 9

- **From North:** Take the 45/46 Bypass to College Avenue; turn right. Take College Avenue to 17th Street; turn left. Take 17th Street to N. Dunn Street; turn left. Enter Gate 9.
- **From South:** Go North on Walnut Street to 17th Street; turn right. Take 17th Street to N. Dunn Street; turn left. Enter Gate 9.
- **From East:** Follow 3rd Street West to Walnut Street; turn right. Take Walnut Street to 17th Street; turn right. Take 17th Street to Dunn Street; turn left. Enter Gate 9.
- **From West:** Take SR 46 to College Avenue; turn right. Take College Avenue to 17th Street; turn left. Take 17th Street to N. Dunn Street; turn left. Enter Gate 9.

### Gates 10 and 11

- **From North:** Take the 45/46 Bypass to Gates 10 and 11.
- **From South:** Head North on Walnut Street to the 45/46 Bypass; turn right. Enter Gate 10 or 11.
- **From East:** Follow 3rd Street West to Walnut Street; turn right. Take Walnut Street to the 45/46 Bypass; turn right. Enter Gate 10 or 11.
- **From West:** Follow SR 46 (becomes the 45/46 Bypass) to Gate 10 or 11.

## WHITE LOT (GATES 5, 6 AND 8)

### Gates 5 and 6

- **From North:** Take the 45/46 Bypass to Fee Lane; turn right. Take Fee Lane to 17th Street; turn right. Enter Gate 5 or 6.
- **From South:** Go North on Walnut Street to the 45/46 Bypass; turn right. Take the 45/46 Bypass to Fee Lane; turn right. Take Fee Lane to 17th Street; turn right. Enter Gate 5 or 6.
- **From East:** Follow 3rd Street/SR 46 to the 45/46 Bypass; turn right. Take the 45/46 Bypass to 17th Street; turn left. Enter Gate 5 or 6.
- **From West:** Follow SR 46 (becomes the 45/46 Bypass) to Fee Lane; turn right. Take Fee Lane to 17th Street; turn right. Enter Gate 5 or 6.

### Gate 8

- **From North:** Take the 45/46 Bypass to College Avenue; turn right. Take College Avenue to 17th Street; turn left. Take 17th Street to N. Dunn Street; turn left. Enter Gate 8.
- **From South:** Go North on Walnut Street to 17th Street; turn right. Take 17th Street to N. Dunn Street; turn left. Enter Gate 8.
- **From East:** Follow 3rd Street West to Walnut Street; turn right. Take Walnut Street to 17th Street; turn right. Take 17th Street to Dunn Street; turn left. Enter Gate 8.
- **From West:** Take SR 46 to College Avenue; turn right. Take College Avenue to 17th Street; turn left. Take 17th Street to N. Dunn Street; turn left. Enter Gate 8.

## ORANGE LOT (GATE 4)

- **From North:** Take the 45/46 Bypass to Fee Lane; turn right. Take Fee Lane to 17th Street; turn right. Enter Gate 4.
- **From South:** Go north on Walnut Street to the 45/46 Bypass; turn right. Take the 45/46 Bypass to Fee Lane; turn right. Take Fee Lane to 17th Street; turn right. Enter Gate 4.
- **From East:** Follow 3rd Street/SR 46 to the 45/46 Bypass; turn right. Take the 45/46 Bypass to 17th Street; turn left. Enter Gate 4.
- **From West:** Follow SR 46 (becomes the 45/46 Bypass) to Fee Lane; turn right. Take Fee Lane to 17th Street; turn right. Enter Gate 4.

## GREEN LOT (GATE 12)

- **From North:** Take the 45/46 Bypass to Fee Lane; turn right. Enter Gate 12.
- **From South:** Go North on Walnut Street to the 45/46 Bypass; turn right. Take the 45/46 Bypass to Fee Lane; turn right. Enter Gate 12.
- **From East:** Follow 3rd Street/SR 46 to the 45/46 Bypass; turn right. Take the 45/46 Bypass to 17th Street; turn left. Take 17th Street to N. Jordan Avenue; turn right. Take N. Jordan Avenue to Fee Lane; turn left. Enter Gate 12.
- **From West:** Follow SR 46 (becomes the 45/46 Bypass) to Fee Lane; turn right. Enter Gate 12.

**For more information on traffic routes and parking, go to [www.IUHoosiers.com](http://www.IUHoosiers.com)**

## MEMORIAL STADIUM PRE-GAME TRAFFIC (cont.)

### BLUE LOT (GATES 2 AND 14)

#### Gate 14

- **From North:** Take the 45/46 Bypass to Fee Lane; turn right. Enter Gate 14.
- **From South:** Go North on Walnut Street to the 45/46 Bypass; turn right. Take the 45/46 Bypass to Fee Lane; turn right. Enter Gate 14.
- **From East:** Follow 3rd Street/SR 46 to the 45/46 Bypass; turn right. Take the 45/46 Bypass to 17th Street; turn left. Take 17th Street to N. Jordan Avenue; turn right. Take N. Jordan Avenue to Fee Lane; turn left. Enter Gate 14.
- **From West:** Follow SR 46 (becomes the 45/46 Bypass) to Fee Lane; turn right. Enter Gate 14.

#### Gate 2

- **From North:** Take the 45/46 Bypass to Fee Lane; turn right. Take Fee Lane to 17th Street; turn right. Enter Gate 2.
- **From South:** Go north on Walnut Street to the 45/46 Bypass; turn right. Take the 45/46 Bypass to Fee Lane; turn right. Take Fee Lane to 17th Street; turn right. Enter Gate 2.
- **From East:** Follow 3rd Street/SR 46 to the 45/46 Bypass; turn right. Take the 45/46 Bypass to 17th Street; turn left. Enter Gate 2.
- **From West:** Follow SR 46 (becomes the 45/46 Bypass) to Fee Lane; turn right. Take Fee Lane to 17th Street; turn right. Enter Gate 2.

### GRASS LOTS

- **From North:** Take the 45/46 Bypass to College Avenue; turn right. Take College Avenue to 17th Street; turn left. Take 17th Street to Dunn Street; turn right. Take Dunn Street to 13th Street; turn left. Turn left onto Woodlawn Avenue, Fess Avenue, Forrest Avenue or Walnut Grove. Enter Grass Lots.
- **From South:** Go North on Walnut Street to 10th Street; turn right. Take 10th Street to Indiana Avenue; turn left. Take Indiana Avenue to 13th Street; turn right. Turn left onto Woodlawn Avenue, Fess Avenue, Forrest Avenue or Walnut Grove. Enter Grass Lots.
- **From East:** Follow 3rd Street/SR 46 to the 45/46 Bypass; turn right. Take the 45/46 Bypass to 10th Street; turn left. Take 10th Street to Fee Lane; turn right. Take Fee Lane to 13th Street; turn left. Turn right onto Woodlawn Avenue, Fess Avenue, Forrest Avenue or Walnut Grove. Enter Grass Lots.
- **From West:** Follow SR 46 (becomes the 45/46 Bypass) to College Avenue; turn right. Take College Avenue to 17th Street; turn left. Take 17th Street to Dunn Street; turn right. Take Dunn Street to 13th Street; turn left. Turn left onto Woodlawn Avenue, Fess Avenue, Forrest Avenue or Walnut Grove. Enter Grass Lots.



# MEMORIAL STADIUM POST-GAME TRAFFIC

- **The 45/46 Bypass will be one-way west** from Fee Lane to Walnut Street (three lanes).
- **Dunn Street will be one-way north** from 17th Street to the 45/46 Bypass (two lanes).
- **Fee Lane will be one-way north** from 17th Street to the 45/46 Bypass (two lanes).
- **17th Street will be one-way west** from Fess Avenue to Walnut Street (two lanes).
- **17th Street will be one-way east** from Woodlawn Avenue to Fee Lane (two lanes).

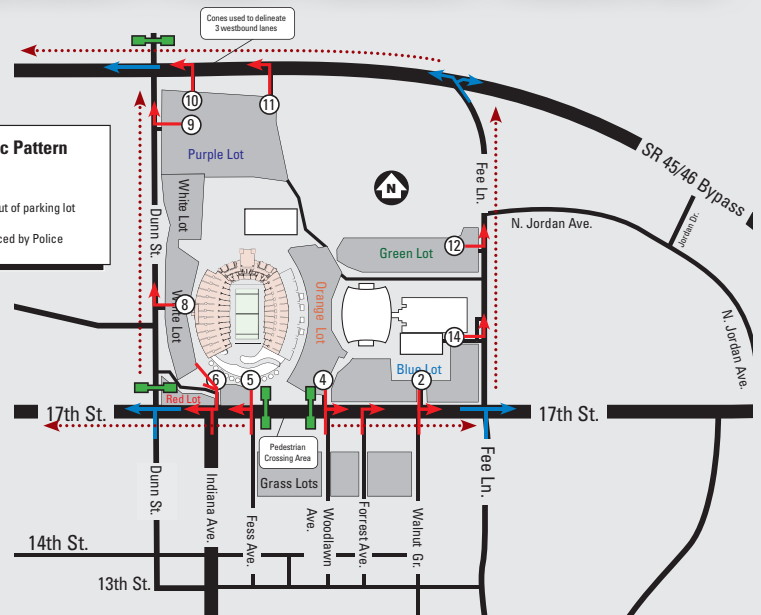

### PURPLE LOT (GATES 9, 10 AND 11)

- Gate 9:** Exit north on Dunn Street to the 45/46 Bypass, then west on the Bypass.  
**Gates 10 and 11:** Exit west onto the 45/46 Bypass.

### WHITE LOT (GATES 5, 6 AND 8)

- Gates 5 and 6:** Exit west on 17th Street and continue on 17th Street to Walnut Street.  
**Gate 8:** Exit north on Dunn Street to the 45/46 Bypass, then west on the Bypass.

### ORANGE LOT (GATE 4)

- Exit east on 17th Street to Fee Lane or the 45/46 Bypass.

### GREEN LOT (GATE 12)

- Exit north on Fee Lane to the 45/46 Bypass.

### BLUE LOT (GATES 2 AND 14)

- Gate 14:** Exit north on Fee Lane to the 45/46 Bypass.  
**Gate 2:** Exit east on 17th Street to Fee Lane or the 45/46 Bypass.

### GRASS LOTS

- Exit north on Fess, Woodlawn or Forrest Avenues.
- From Fess Avenue, turn left on 17th Street and continue west to Walnut Street.
  - From Woodlawn and Forrest Avenues, turn right onto 17th Street to Fee Lane or the 45/46 Bypass.

**For more information on traffic routes and parking, go to [www.IUHoosiers.com](http://www.IUHoosiers.com)**